

# ACTUATORS

## GOLD SEAL COMBINATION / PIGGYBACK BRAKES

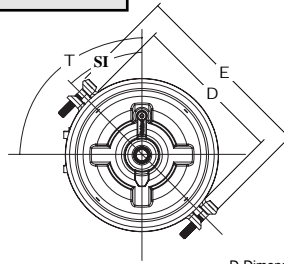

SERVICE DIAPHRAGM

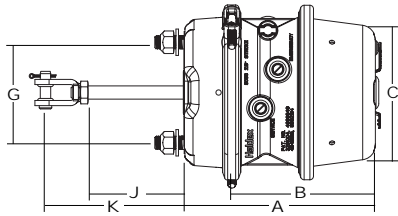
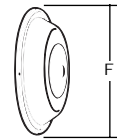

J-Face of the stud housing to the tip of the service push rod  
 K-Face of the stud housing to the center of the main clevis pin  
 A-Length of the chamber from face of the stud housing to the end of spring housing  
 B-Length of piggyback center body to end of spring housing  
 C-Dimension at spring housing

D-Dimension at Rolled Seal  
 E-Dimension at Service Clamp Band  
 F-Dimension of Service Diaphragm  
**Note:** Angles are measured counter-clockwise with the studs in the vertical position and viewed from the spring housing

Stud Spacing (G): 4.75" - 121 mm  
 Stud Type: 5/8 x 11 UNC Grade 5  
 Stud Length: 1.50" - 38 mm

Push Rod Thread: 5/8 x 11 UNF  
 Air Port Threads: 3/8 x 18 NPTF

Model Size / Type	Available Stroke		Service C.U.IN.	Spring C.U.IN.	A		B		C		D		E		F		Mass Piggyback		Mass Combination	
	inch	mm			inch	mm	inch	mm	inch	mm	inch	mm	inch	mm	inch	mm	lbs	kg	lbs	kg
1624	2.25	57	NA	72.5	NA	NA	6.3	160	5.9	150	7.5	191	NA	NA	NA	NA	10.0	4.5	NA	NA
2024	2.25	57	53.0	72.5	8.5	216	6.3	160	5.9	150	7.5	191	8.9	226	6.5	165	10.3	4.7	17.0	7.7
2030	3.00	76	92.0	116.4	9.6	244	7.8	198	6.3	160	8.3	211	9.4	239	7.1	180	18.9	8.6	21.9	9.9
2424	2.25	57	63.0	72.5	8.5	216	6.3	160	5.9	150	7.5	191	9.6	244	7.1	180	10.5	4.8	17.5	7.9
2424	2.50	64	69.5	86.9	8.9	226	5.4	137	5.4	137	7.4	188	9.2	234	7.1	180	11.0	5.0	18.0	8.2
2430	2.50	64	69.5	103.5	9.0	229	6.7	170	6.3	160	8.4	213	9.3	236	7.1	180	12.1	5.5	19.9	9.0
2430	3.00	76	92.0	116.4	9.6	244	7.8	198	6.6	168	8.3	211	9.4	239	7.1	180	18.9	8.6	21.9	9.9
3030	2.50	64	87.5	97.0	9.0	229	6.7	170	6.3	160	8.3	211	9.2	234	7.8	198	11.8	5.4	19.6	8.9
3030	3.00	76	92.0	116.4	9.5	241	7.2	183	6.3	160	8.3	211	10.2	259	7.8	198	12.3	5.6	20.6	9.3
3036	2.50	64	87.5	145.0	9.6	244	7.3	185	7.2	183	9.2	234	9.7	246	7.8	198	15.7	7.1	26.0	11.8
3036	3.00	76	109.0	167.0	10.9	277	8.5	216	7.2	183	8.2	208	9.1	231	7.8	198	15.7	7.1	26.0	11.8
3636	3.00	76	128.0	145.0	10.4	264	8.0	203	7.2	183	9.4	239	11.2	284	8.7	221	16.4	7.4	26.0	11.8

### Gold Seal (GC - Combination, GP - Piggyback)

Model Size / Type	Available Stroke		Aftermarket Part Number		Qty per Pack	Push Rod Length**		T (PA) Port Angle **	SI (SCA) Service Clamp Angle**
	inch	mm	Combination	Piggyback		J (inches)	K (inches)		
1624	2.25	57	NA	GP1624	2	NA	NA	NA	NA
2024	2.25	57	GC2024	GP2024	2	9.68	NA	90 °	0 °
2424	2.25	57	GC2424	GP2424	2	9.65	NA	90 °	0 °
2424	2.50	64	GC2424L	GP2424L	2	9.50	NA	90 °	0 °
2430	2.50	64	GC2430L	GP2430L	2	9.50	NA	90 °	0 °
2430	3.00	76	GC2430XL	GP2430XL	1	8.60	NA	90 °	0 °
3030	2.50	64	GC3030	GP3030	2	10.00	NA	90 °	0 °
			GC3030R	NA	1	14.00	NA	90 °	0 °
			GC3030P40	GP3030P40	40	10.00	NA	90 °	0 °
3030	3.00	76	GC3030L	GP3030L	2	10.00	NA	90 °	0 °
			GC3030LR	NA	1	14.00	NA	90 °	0 °
			GC3030LP40	GP3030LP40	40	10.00	NA	90 °	0 °
3036	2.50	64	GC3036	GP3036	2	9.44	NA	90 °	0 °
3036	3.00	76	GC3036L	GP3036L	2	9.00	NA	90 °	0 °
3636	3.00	76	GC3636	GP3636	2	10.00	NA	90 °	0 °
<b>With Clevis, Stamped (CS)</b>									
3030	2.50	64	GC3030CS	NA	1	10.00	11.25	90 °	0 °
			GC3030CSP40	NA	40	10.00	11.25	90 °	0 °
<b>With Clevis, Forged (CF)</b>									
3030	2.50	64	GC3030CF	NA	1	10.00	11.25	90 °	0 °
			GC3030CFP40	NA	40	10.00	11.25	90 °	0 °
<b>With Clevis, Forged (CF) and Push Rod Dust Boot (B)</b>									
3030	2.50	64	GC3030CFB	NA	1	10.00	11.25	90 °	0 °
			GC3030CFBP40	NA	40	10.00	11.25	90 °	0 °
<b>Gold Seal Piggyback Kits (K) (Piggyback, Diaphragm and Clamp Assembly)</b>									
3030	2.50	64	NA	GP3030K	1	NA	NA	NA	NA
			NA	GP3030KP40	40	NA	NA	NA	NA
3030	3.00	76	NA	GP3030LK	1	NA	NA	NA	NA
			NA	GP3030LKP40	40	NA	NA	NA	NA

\*\* Applies to combination assemblies only.